

3RD ANNUAL

# Love & Literacy

## Magic Happens with Reading

**March 9, 2024**  
**10 am to 2 pm**

**FUN  
ACTIVITIES!**

**FOOD!**

**FREE  
BOOKS!**

**ASL  
STORYTELLING!**

**MAGIC  
SHOW!**

**SURPRISE  
GIFT!**

**First Presbyterian Church  
Fellowship Hall  
1540 M Street  
Fresno, CA 93721**



**For more information,  
contact Shelley Stout  
at 559-225-3323 Voice,  
559-578-4117 VP, or  
shelleys@dhhsc.org**

CA EHDI:  
**LEAD-K**  
LANGUAGE EQUALITY & ACQUISITION FOR DEAF KIDS  
A PROGRAM OF MORCAL SERVICES FOR DEAF & HARD OF HEARING  
*Family Services*

<https://www.leadkfamilyservices.org>

**SUPPORTED  
BY**



Connect. Inspire. Succeed.

**DHHSC**

DEAF & HARD OF HEARING SERVICE CENTER

3RD ANNUAL

# Love & Literacy

MAP OF  
DOWNTOWN FRESNO

## Campus Map

First Presbyterian Church, Fresno

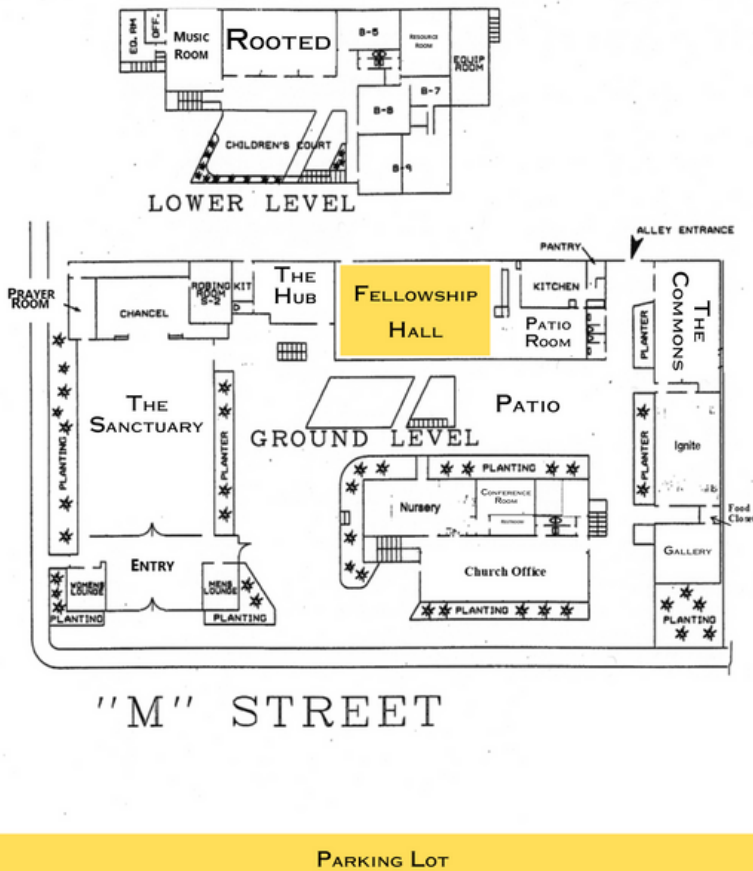

- LOCATED IN DOWNTOWN FRESNO ON M STREET
- PARKING LOT IS FREE
- CONTACT SHELLEY STOUT FOR MORE INFORMATION

# SEE YOU THEN!

CA EHD: **LEAD-K**  
LANGUAGE EQUALITY & ACQUISITION FOR DEAF KIDS  
A PROGRAM OF NORCAL SERVICES FOR DEAF & HARD OF HEARING

*Family Services*

<https://www.leadfamilyservices.org>

SUPPORTED  
BY

Connect. Inspire. Succeed.  
**DHHSC**  
DEAF & HARD OF HEARING SERVICE CENTER